

INCUBATOR SPECS

- New state-of-the-art modules
- Co-located with IIT biomedical and chemical engineering research labs
- Accommodating 30+ companies
- Combines wet lab/dry lab and office space (300 to 2,000 square feet)
- Private entrances
- Flexible design to meet company-specific needs
- No floor-load restrictions
- High-purity water (RO)
- Shared equipment space with:
 - Autoclave
 - Glass sterilizer
 - Counter and sink
 - Refrigerator/freezer
 - Centrifuge
 - Icemaker
- Breakroom space with counter and sink
- Conference room

Wet Laboratory Facilities

- Metal casework with epoxy resin top
- Sink with hot and cold water, RO water, and eyewash
- Natural gas, compressed air, and vacuum on bench top
- Two bench-top spigots for other gases, piped to tank rack
- Drying rack and stainless steel shelf
- Fume hood with Phoenix variable volume control and cup sink
- Equipment space with 120V receptacles on 3-foot module in wiremold
- One 120V receptacle with emergency power backup
- One 208V receptacle
- Emergency shower and eyewash
- Direct/indirect lighting
- Seamless vinyl or sealed concrete floor with cove base
- Office space adjacent to laboratory
- Wall marker board

Dry Laboratory Facilities

- 120V receptacles on 3-foot module in wiremold
- 208V receptacle
- Direct/indirect lighting
- Vinyl tile or sealed concrete floor
- Wall marker board

Building Services

- Copier and mail service
- 24/7 access and building operation
- Secure key card access
- IIT security services
- Telecom and high-speed Internet access provided by IIT

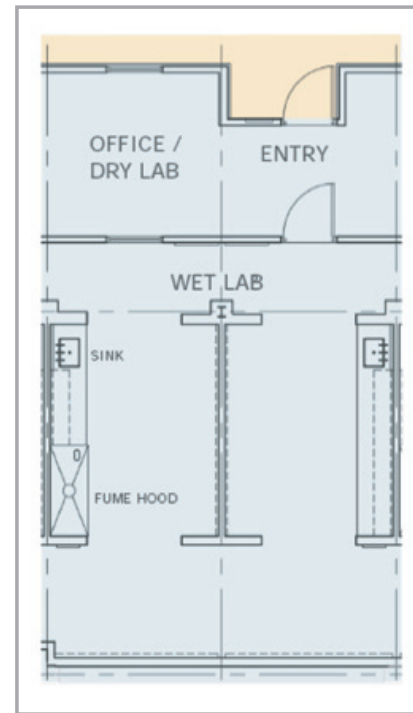

INCUBATOR WET LAB MODULE (1,000 square feet)

