

# Connecting to Wireless at Illinois Institute of Technology

## Apple iPhones and iPads

1. Ensure your Wi-Fi is turned on.
2. Select **IIT-Secure** from the list of available wireless networks.

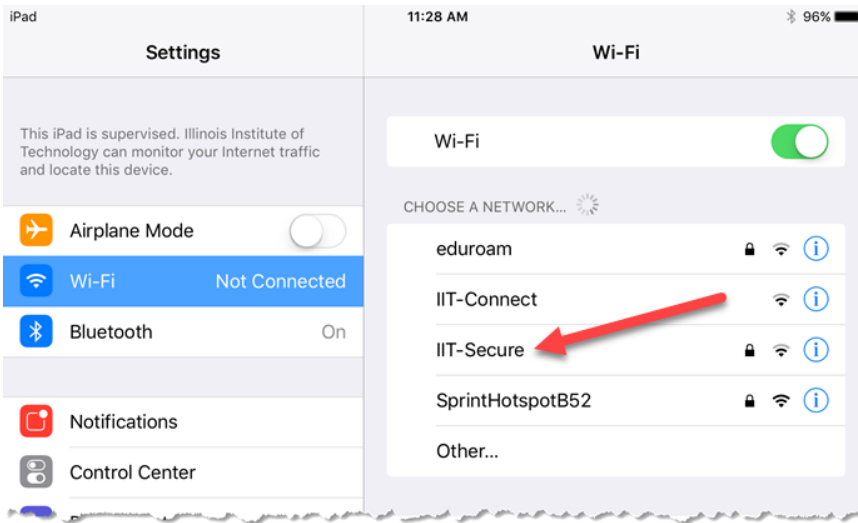

3. Enter your Illinois Tech **full email address** in the **Username** field and then your **password**.

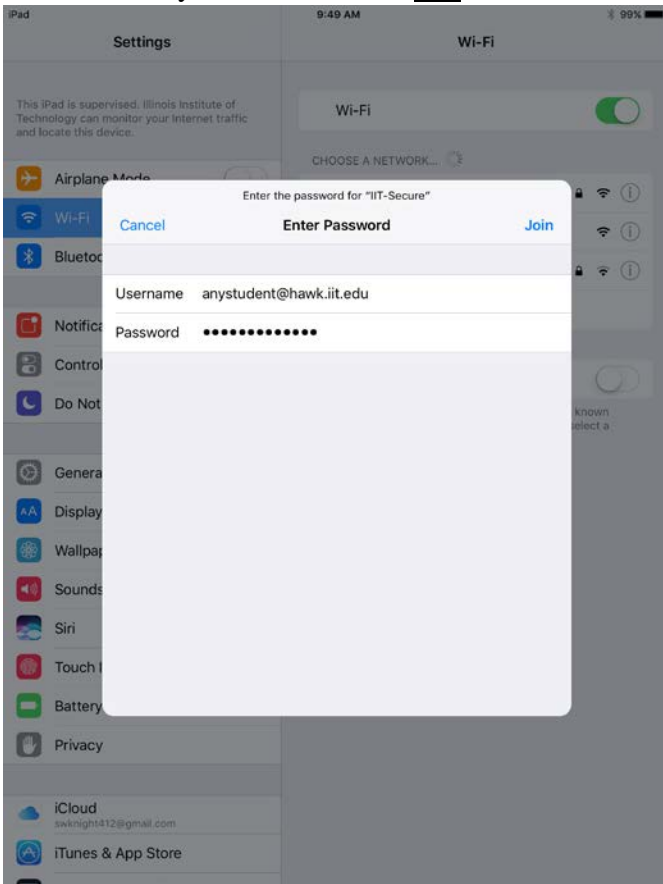

4. Tap **Trust** in the upper right-hand corner.

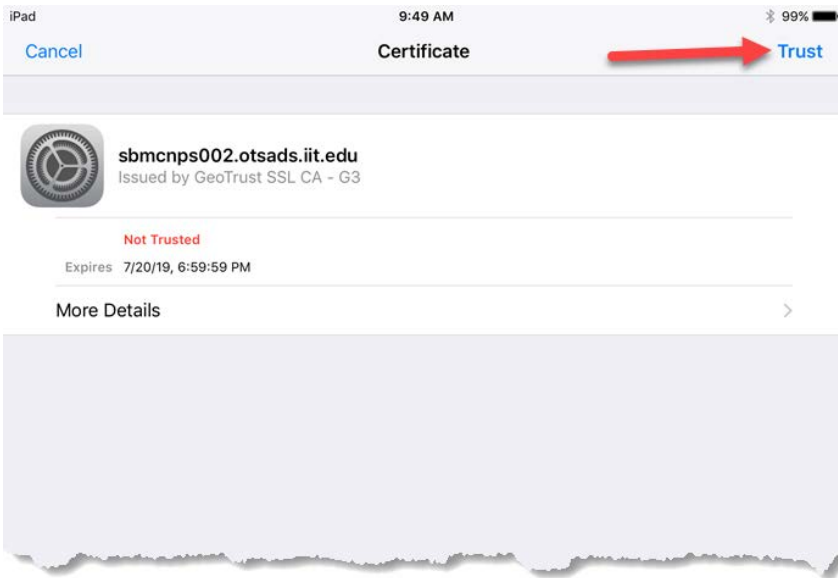

**If you need assistance, please contact:**

**OTS Support Desk**

**Phone: 312-567-3375 (x7DESK)**

**Email: [supportdesk@iit.edu](mailto:supportdesk@iit.edu)**

**In-person: Galvin Library, Upper Level**